

COPY RIGHT OF THIS DRAWING BELONGS TO M/S S.S CONSULTANTS AND SHOULD NOT BE USED FOR ANY PURPOSE OTHER THAN SPECIFIED WITHOUT PRIOR PERMISSION

NORTH :

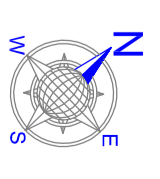

JOINERY SCHEDULE :

TYPE	NAME	SIZE	QTY	F.F.	S.F.
WOODEN WARD ROOMS	WARD	800x2000	1	-	-
WOODEN DOORS	WOT	1500x2100	2	-	-
WOODEN DOORS	WOD	1500x2100	6	1	-
WOODEN DOORS	WOD	800x2100	62	28	18
PRIE PAINTED STEEL WINDOWS	PWA	1500x1200	60	70	12
PRIE PAINTED STEEL WINDOWS	PWA	1500x600	2	-	-
PRIE PAINTED STEEL WINDOWS	PWA	1500x600	18	18	8
PRIE PAINTED STEEL VENTILATORS	PVZ	800x500	57	57	10

OCCUPANCY

FLOOR	No. OF ROOMS	OCCUPANCY PER ROOM	TOTAL No. OF PERSONS
GROUND FLOOR	40	2	80
FIRST FLOOR	42	2	84
SECOND FLOOR	12	2	24
TOTAL	94		188

AREAS :

GROUND FLOOR AREA	2442.75 Sq.M
FIRST FLOOR AREA	2392.00 Sq.M
SECOND FLOOR AREA	642.00 Sq.M
TOTAL AREA	5436.75 Sq.M
PORTICO	66.0 Sq.M

PROJECT :
ARCHITECTURAL WORKING DRAWING

PROJECT :
RAJIV GANDHI INSTITUTE OF MEDICAL SCIENCES (RIMS) AT ADILABAD, T.S.

TITLE :
GIRLS HOSTEL FIRST FLOOR PLAN

CLIENT :
TELANGANA MEDICAL SERVICES
INFRASTRUCTURE DEVELOPMENT CORPORATION
(An Enterprise of Government of Telangana)
DM & HS CAMPUS
SULTAN BAZAR, KOTI, HYDERABAD.

CONSULTANTS :
S.S. CONSULTANTS
PROJECT CONSULTANTS
#1749, JABBAR BUILDINGS,
BEQUALET, HYDRABAD-16
PH: 66310240, 66310954,
FAX NO: 040-66312949,
email: ssecos@ssconsultants.com

DATE : 13-10-2010
SCALE : 1:150
DEALT BY : LAXMI V
ARCHITECT : N.V.S. RAO
CHECKED BY : S.S. RAO

SHEET NO: **06A**

DRG NO:- SS/TMS/DC/ADILABAD/GIRLS HOSTEL/FF-21

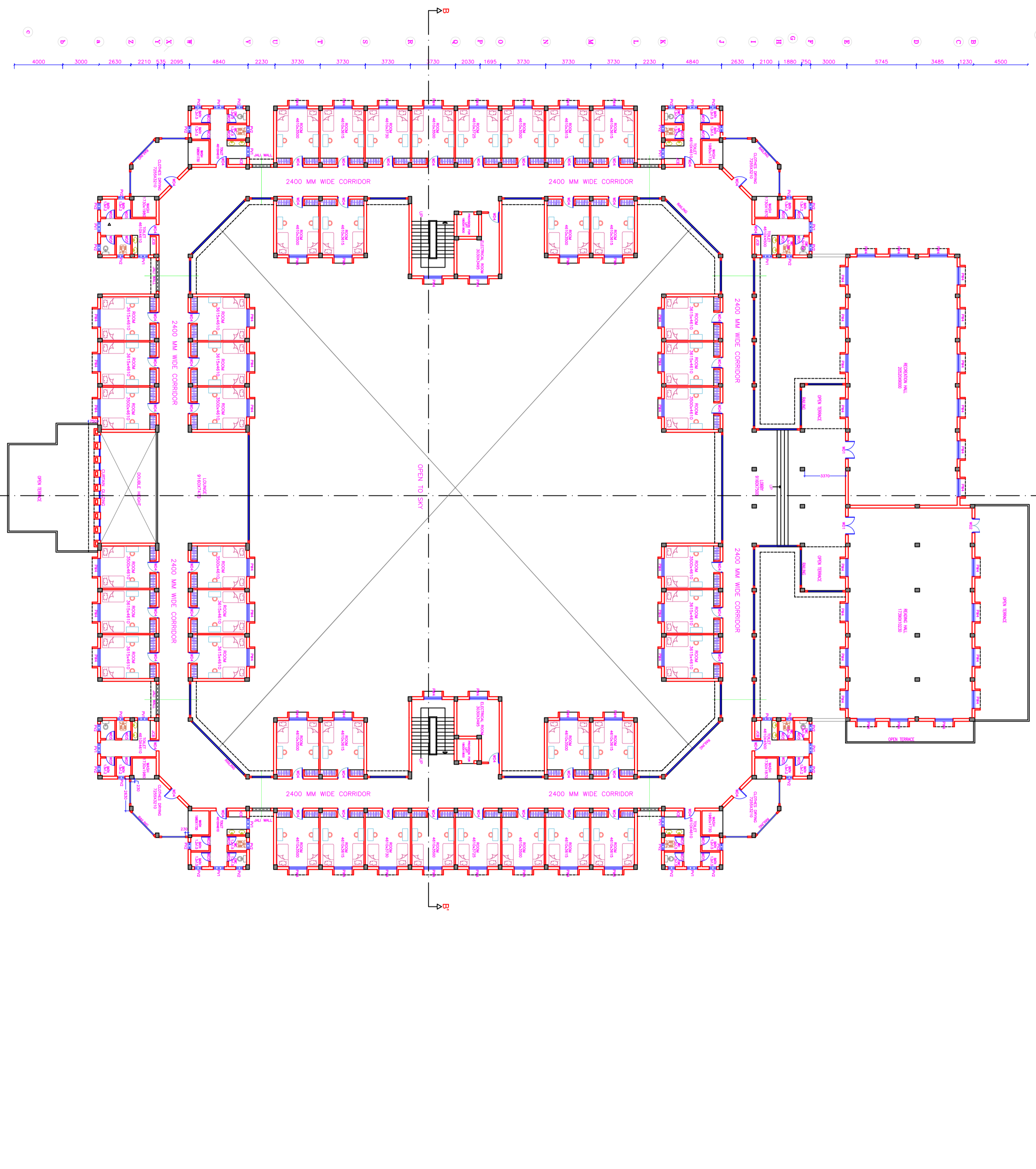

12 11 10 9 8 7 6 5 4 3 2 1

A B C D E F G H

COPY RIGHT OF THIS DRAWING BELONGS TO M/S S.S CONSULTANTS AND SHOULD NOT BE USED FOR ANY PURPOSE OTHER THAN SPECIFIED WITHOUT PRIOR PERMISSION

NORTH :

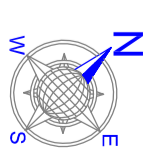

JOINERY SCHEDULE :

TYPE	NAME	SIZE	QTY	F.F.	S.F.
WOODEN WARD ROOMS	WARD	800x2000	1	-	-
WOODEN DOORS	WOT	1500x2100	2	-	-
WOODEN DOORS	WOD	750x2100	6	1	-
WOODEN DOORS	WOD	800x2100	62	28	18
WOODEN DOORS	WOD	750x2100	32	32	18
PRIE PAINTED STEEL WINDOWS	PWA	1500x1200	60	70	12
PRIE PAINTED STEEL WINDOWS	PWA	1500x600	2	-	-
PRIE PAINTED STEEL WINDOWS	PWA	1500x600	2	-	-
PRIE PAINTED STEEL VENTILATORS	PV1	1500x500	18	18	8
PRIE PAINTED STEEL VENTILATORS	PV2	800x500	57	57	10

OCCUPANCY

FLOOR	No. OF ROOMS	OCCUPANCY PER ROOM	TOTAL No. OF PERSONS
GROUND FLOOR	40	2	80
FIRST FLOOR	42	2	84
SECOND FLOOR	12	2	24
TOTAL	94		188

AREAS :

GROUND FLOOR AREA	2442.75 Sq.M
FIRST FLOOR AREA	2382.00 Sq.M
SECOND FLOOR AREA	642.00 Sq.M
TOTAL AREA	5436.75 Sq.M
PORTICO	66.0 Sq.M

PROJECT :
ARCHITECTURAL WORKING DRAWING

PROJECT :
RAJIV GANDHI INSTITUTE OF MEDICAL SCIENCES (RIMS) AT ADILABAD, T.S

TITLE :
GIRLS HOSTEL
GROUND FLOOR PLAN

CLIENT :
TELANGANA MEDICAL SERVICES
INFRASTRUCTURE DEVELOPMENT CORPORATION
(An Enterprise of Government of Telangana)
DM & HS CAMPUS
SULTAN BAZAR, KOTI, HYDERABAD.

CONSULTANTS :
S.S. CONSULTANTS
PROJECT CONSULTANTS
#1749, JABBAR BUILDINGS,
BEQUAFET, HYDRABAD-16
PH: 66310240, 66310954,
FAX NO: 040-66312949,
email: ssecos@rediffmail.com

DATE : 13-10-2010
SCALE : 1:150
DEALT BY : LAXMI.V
ARCHITECT : N.V.S. RAO
CHECKED BY : S.S.RAO

SHEET NO: 06

DRG.NO:-SS7MSIDCADILABADGIRLS HOSTEL/GF-20

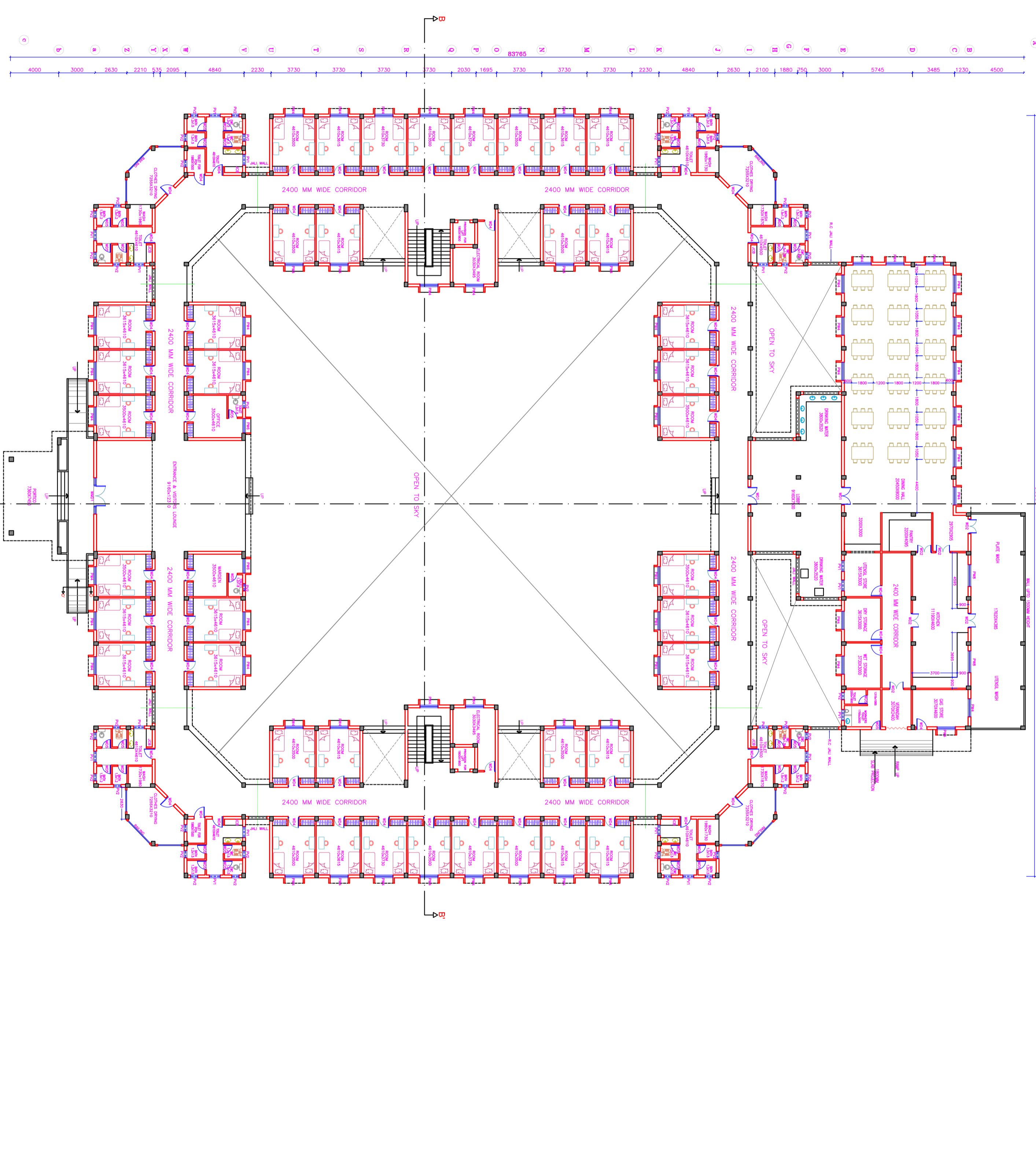

12 11 10 9 8 7 6 5 4 3 2 1

COPY RIGHT OF THIS DRAWING BELONGS TO M/S S.S CONSULTANTS AND SHOULD NOT BE USED FOR ANY PURPOSE OTHER THAN SPECIFIED WITHOUT PRIOR PERMISSION

NORTH :

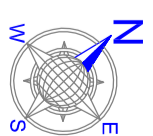

JOINERY SCHEDULE :

TYPE	NAME	SIZE	QTY	F.F.	S.F.
WOODEN WARD ROOMS	WRM1	5000x2000	1	-	-
WOODEN DOORS	WOT	1500x2100	7	-	-
WOODEN DOORS	WOD	1500x2100	6	1	-
WOODEN DOORS	WOD	800x2100	62	28	18
PRE PAINTED STEEL WINDOWS	PWS	1500x1200	60	70	12
PRE PAINTED STEEL WINDOWS	PWS	1500x600	2	-	-
PRE PAINTED STEEL VENTILATORS	PV1	800x500	18	18	8
PRE PAINTED STEEL VENTILATORS	PV2	500x500	57	57	10

OCCUPANCY

	No. OF ROOMS	OCCUPANCY PER ROOM	TOTAL No. OF PERSONS
GROUND FLOOR	40	2	80
FIRST FLOOR	42	2	84
SECOND FLOOR	12	2	24
TOTAL	94		188

AREAS :

GROUND FLOOR AREA	2442.75 Sq.M
FIRST FLOOR AREA	2392.00 Sq.M
SECOND FLOOR AREA	642.00 Sq.M
TOTAL AREA	5436.75 Sq.M
PORTICO	66.0 Sq.M

PROJECT :

ARCHITECTURAL WORKING DRAWING

PROJECT :

RAJIV GANDHI INSTITUTE OF MEDICAL SCIENCES (RIMS) AT ADILABAD, T.S.

TITLE :

GIRLS HOSTEL SECOND FLOOR PLAN

CLIENT :

TELANGANA MEDICAL SERVICES
INFRASTRUCTURE DEVELOPMENT CORPORATION
(An Enterprise of Government of Telangana)
DM & HS CAMPUS
SULTAN BAZAR, KOTI, HYDERABAD.

CONSULTANTS :

S.S. CONSULTANTS
PROJECT CONSULTANTS
#1749, JABBAR BUILDINGS,
BEQUALET, HYDERABAD-16
Ph: 66310240, 66310954,
Fax No: 040-66312949,
email: ssecna1749@rediffmail.com

DATE :

01/09/2010

SCALE :

1:150

DEALT BY :

RANJITH G

ARCHITECT :

N.V.S. RAO

CHECKED BY :

S.S. RAO

06B

DRG.NO:-SS17MSIDCADILABADGIRLS HOSTEL/SF-22

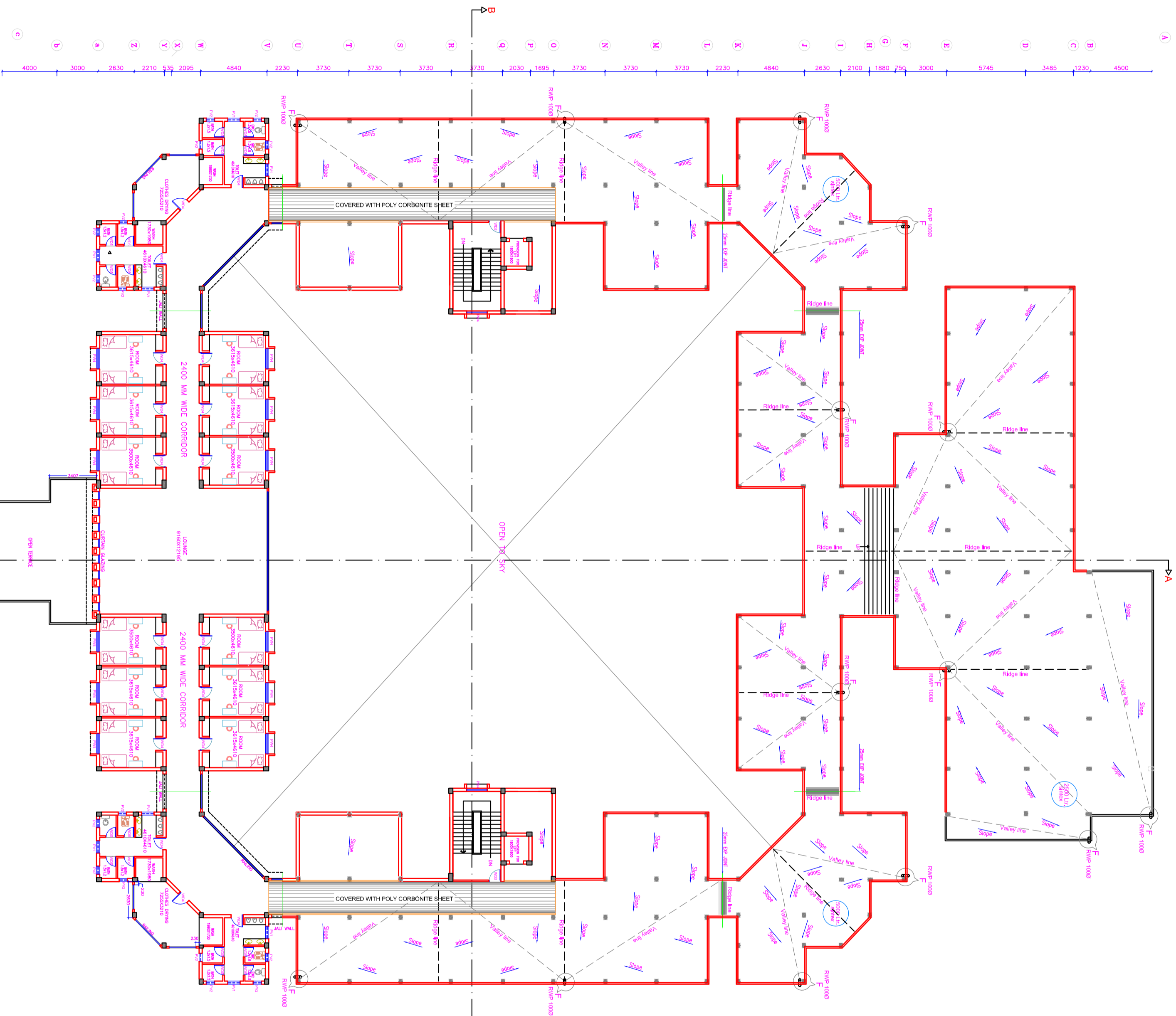

Grid lines: A-H (vertical), 1-30 (horizontal). Dimensions are provided for each grid interval.